

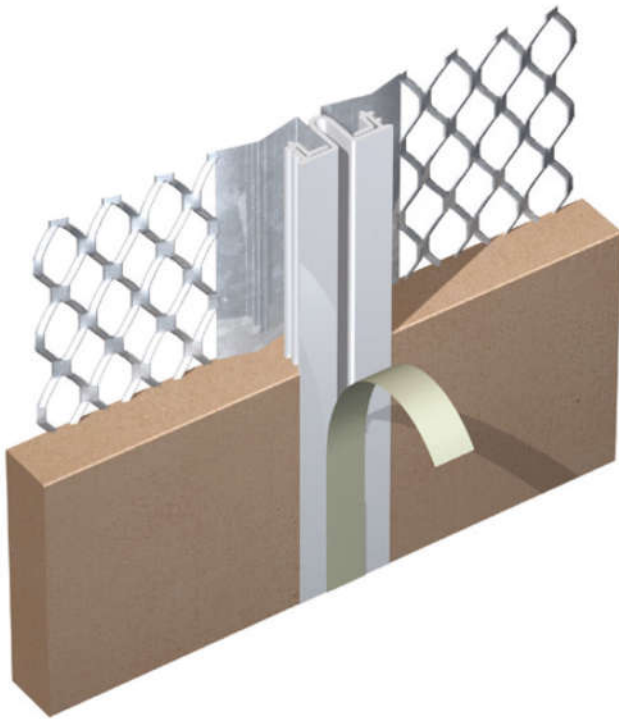

## 590E3000

### GALLERY



### PRODUCT ATTRIBUTES

<b>Brand</b>	Expamet
<b>Generic Ref</b>	590
<b>Product Range</b>	Plasterers Accessories
<b>Product Sub-range</b>	Multi-coat plaster beads and lath - Internal Use
<b>Product Type</b>	Movement Bead
<b>European Standard/ETA</b>	BS EN13658-1:2005
<b>DoP Ref</b>	EXP101CPR2013
<b>Material</b>	Galvanized Mild Steel DX51D+Z275 to EN10346:2015
<b>Coating/Finish/Colour</b>	275g/m <sup>2</sup> Zinc Coating

<b>Length 1/Projection</b>	3000mm
<b>Width/Wing Length</b>	119mm Width
<b>Plaster/Render/Joist depth</b>	21mm Plaster Depth
<b>Material Gauge</b>	0.4mm
<b>Individual Weight (kg)</b>	1.285
<b>Fire Rating</b>	Reaction to fire: Class E
<b>Fixing Type</b>	Plaster/Grab Adhesive/Nails/Staples
<b>Installation requirement 1</b>	Fix at intervals not exceeding 600mm
<b>Installation requirement 2</b>	Beads may be wire tied to the face of metal lathing backgrounds
<b>Installation requirement 3</b>	Avoid damage to beads when trowelling. Do not use abrasives to clean beads.
<b>Installation requirement 4</b>	When used over metal lathing, ensure there is a break in the lath coincident with the bead nosing.
<b>Installation requirement 5</b>	Peel off protective strip once plastering is complete.
<b>Unit of Sale EAN</b>	5014316000284
<b>Sales Qty</b>	12
<b>Packaging material</b>	Cardboard
<b>Carton Ref</b>	XBP5703014
<b>Carton/Size</b>	220 x 100 x 3019
<b>Packaging weight</b>	0.898
<b>Packaged transit weight</b>	16.318
<b>Features/Benefits 1</b>	Expanded wing reinforces plaster to prevent cracking
<b>Features/Benefits 2</b>	Provides a straight edge and protects plaster edges from damage
<b>Features/Benefits 3</b>	Can easily be cut to size using tin-snips or aviation cutters
<b>Features/Benefits 4</b>	Allows movement of +3/-1mm
<b>Options 1</b>	None

## HEALTH AND SAFETY INFORMATION

### 1. Identification

'Expamet'  
Birtley Group Ltd  
Mary Ave,  
Birtley,  
DH3 1JF  
UNITED KINGDOM  
(0191) 410 6631

### 2. Composition

Galvanized Mild Steel DX51D+Z275 to EN10346:2015

### 3. Hazards Identification

Possible cuts from sharp steel edges.  
Toxic and irritant fumes from high temperatures

### 4. First aid measures

Skin and eye contact: Treat cuts from steel edges as required.  
Ingestion: Not applicable.  
Inhalation: Remove from source of fumes and dust.

### 5. Fire fighting measures

Non-flammable material.

### 6. Accidental release measures

Not applicable.

### 7. Handling and storage

Bands and straps must not be used for lifting.  
Use suitable PPE when handling products.  
Assess manual handling risks before lifting.  
Products should be stacked on firm level ground in dry conditions.

### 8. Exposure controls

Wear personal protection such as gloves and safety goggles when handling products.  
Some products may have a film of soluble cutting fluid after manufacture; therefore carry out personal hygiene including proper washing of hands, after contact.

### 9. Physical and chemical properties

Products are supplied in various lengths, widths and gauges.  
Metallic grey appearance.

### 10. Stability and reactivity

Products are stable under normal conditions but if subjected to high temperatures, fumes are produced.

### 11. Toxicological information

High temperatures can produce fumes.

### 12. Ecological information

No known Hazard.

### 13. Disposal considerations

Recycle or dispose of in accordance with Waste Management Licensing Regulations.

### 14. Transport information

Not classified as hazardous for transport.

### 15. Regulatory information

Products are articles and have no registration obligation under REACH.

**16. Other information**

All products must be installed in accordance with Expamet Building Products' published instructions.

Where structural products are to be removed from an existing installation, care must be taken to ensure that the procedure followed does not compromise the loading/installation restrictions applicable to the products.

Actual fixing installations must comply with current Health and Safety requirements.